

## Material

- Main body: pressed brass type CW617, nickel-plated from the outside, on surfaces, which do not have contact with water –  
- full anti-diffusion barrier
- Clamping ring: stainless steel
- O-ring gasket: EPDM

## Area of application

- Installations of hot & cold tap water
- Central heating (radiator connections)
- Surface heating (underfloor and wall heating installations)
- Ice water

## Dimensions

Size	L1	L2	L3	L4	D	Code
16x16	26	26	43,3	43,3	11,8	06012003
18x18	26	26	47	47	13,8	06012005
20x20	26	26	48,5	48,5	15,8	06012007
25x25	32,6	32,6	59,7	59,7	19,8	06012009
32x32	32,6	32,6	65,5	65,5	25,8	06012011
40x40	47,5	47,5	85,1	85,1	31,8	06012013
50x50	47,5	47,5	96	96	40,8	06012015
63x63	71	71	131,5	131,5	50,7	06012017
75x75	71	71	141,5	141,5	59,7	06012019

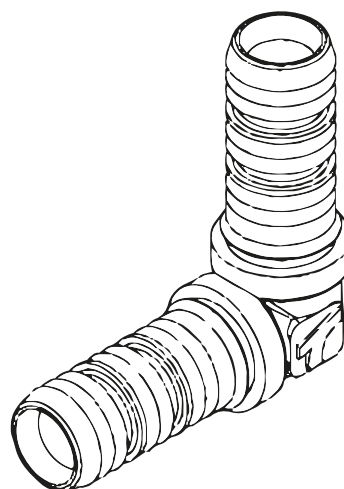
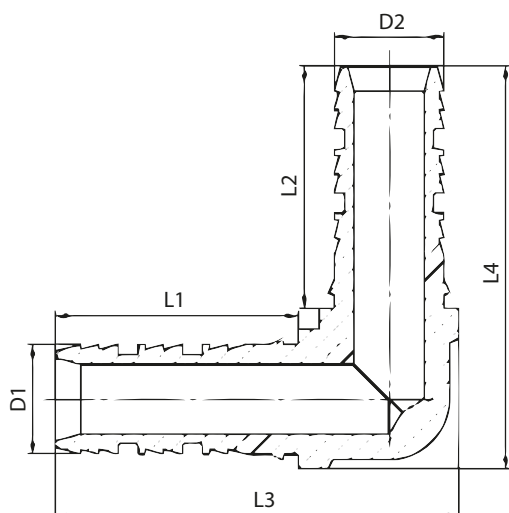

## Overview

The connection between the pipe and the fitting is obtained by pressing the pipe into the fitting's profile. The pressing should be made in the connection area, with a pressing tool equipped with U-type inserts, matched to the type of fitting used. The tightness of the connection chamber is guaranteed by two O-rings, perfectly integrated into the joint area. Pressed connections can be used in the floor groove or a wall furrow.

## Scope of delivery

Main body with sealing and clamping rings